

# MARION TOWNSHIP SECTION 24 R12 TWP 8 MORGAN COUNTY, OH

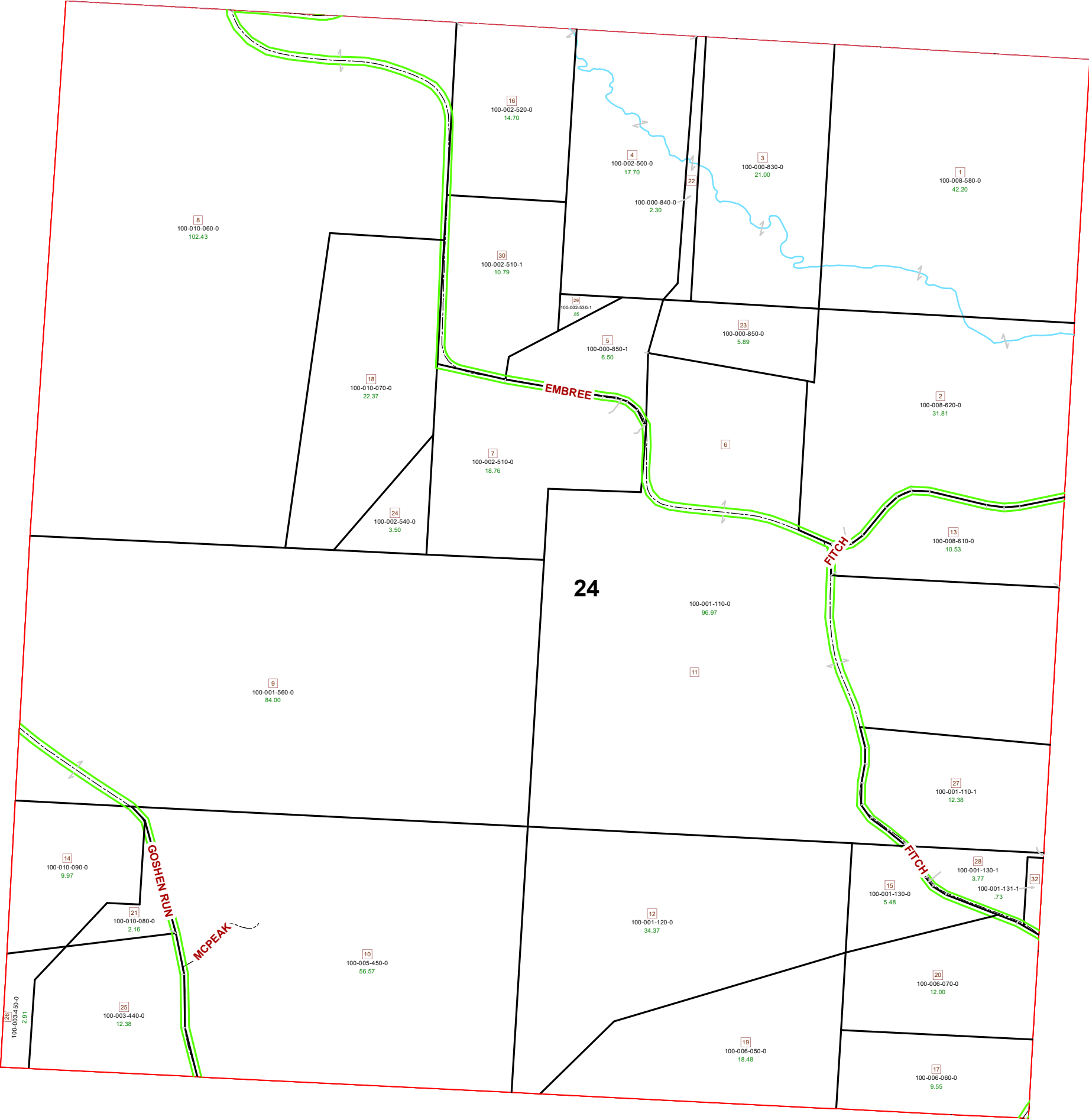

PIN	Owner	VOL	PAGE	LegalDescr	Acres
100-001-560-0	DOUGAN GLEN E TRUSTEE	OR202	1749	R12 T08 S24 SD 9	84
100-010-070-0	FRONCEK TEDDY JOE	OR49	526	R12 T08 S24 SD 18	22.37
100-010-060-0	FRONCEK TEDDY JOE	OR49	526	R12 T08 S24 SD 8	102.43
100-008-610-0	GOSHEN RUN FARMS LLC	OR220	754	R12 T08 S24 SD 13	10.536
100-003-450-0	GREEN BETTY J	OR211	1160	R12 T08 S24 SD 26	2.91
100-003-440-0	GREEN BETTY J	OR211	1160	R12 T08 S24 SD 25	12.385
100-005-450-0	GREEN BETTY J TOD-JAMES RICKY MEA	OR167	429	R12 T08 S24 SD 10	56.57
100-002-540-0	GUINN CHASE A & JENNA L	OR225	2783	R12 T08 S24 SD 24	3.5
100-002-510-0	GUINN CHASE A & JENNA L	OR225	2783	R12 T08 S24 SD 7	18.76
100-010-080-0	HART CHARLES 1/3 & RHONDA KAY BIR	OR58	470	R12 T08 S24 SD 21	2.165
100-010-090-0	HART CHARLES 1/3 & RHONDA KAY BIR	OR58	470	R12 T08 S24 SD 14	9.97
100-000-850-1	MILLIGAN JOSEPH M & DEBBIE L	OR78	98	R12 T08 S24 SD 31	6.5
100-001-131-1	ONEAIL TERRY	OR119	782	R12 T08 S24 SD 32	0.739
100-008-620-0	TOMLINSON GARY L & ANN E TRUSTEE	OR203	3393	R12 T08 S24 SD 2	31.816
100-008-580-0	TOMLINSON GARY L & ANN E TRUSTEE	OR203	3393	R12 T08 S24 SD 1	42.2
100-000-850-0	WILSON HARLAN B & PAMELA G	OR58	494	R12 T08 S24 SD 23	5.89
100-002-530-1	WILSON HARLAN B & PAMELA G	OR67	558	R12 T08 S24 SD 29	0.85
100-002-510-1	WILSON HARLAN B & PAMELA G	OR67	558	R12 T08 S24 SD 30	10.79
100-000-830-0	WILSON HARLAN B & PAMELA G	OR58	494	R12 T08 S24 SD 3	21
100-000-840-0	WILSON HARLAN B & PAMELA G	OR58	494	R12 T08 S24 SD 22	2.3
100-002-500-0	WILSON HARLAN B & PAMELA G	OR67	558	R12 T08 S24 SD 4	17.7
100-002-520-0	WILSON HARLAN B & PAMELA G	OR67	558	R12 T08 S24 SD 16	14.7
100-001-130-1	ZAROS JOHN & REGINA TRUSTEE	OR209	1915	R12 T08 S24 SD 28	3.777
100-001-110-1	ZAROS JOHN & REGINA TRUSTEE	OR209	1915	R12 T08 S24 SD 27	12.388
100-001-130-0	ZAROS JOHN G & REGINA	D.V 184	577	R12 T08 S24 SD 15	5.484
100-006-060-0	ZAROS JOHN TRUSTEE	OR73	710	R12 T08 S24 SD 17	9.55
100-006-050-0	ZAROS JOHN TRUSTEE	OR73	710	R12 T08 S24 SD 19	18.48
100-006-070-0	ZAROS JOHN TRUSTEE	OR73	710	R12 T08 S24 SD 20	12
100-001-120-0	ZAROS ROSENE & JOHN & REGINA	D.V 184	577	R12 T08 S24 SD 12	34.37
100-001-110-0	ZAROS ROSENE & JOHN & REGINA	D.V 184	577	R12 T08 S24 SD 6-	96.972



Boundaries	
----- Hidden	--- ROW
--- Hydro	--- Section
--- Roads	--- Lot
--- County	--- Parcel
----- Township	--- Parcels

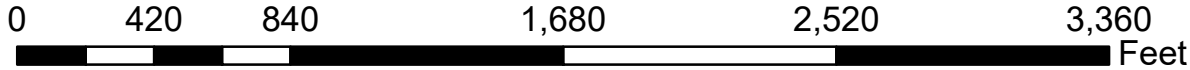

Disclaimer: The information that these maps contains is for reference purposes only. Please bring any errors to the attention of the Engineer's Office staff.  
Thank you

Source: Morgan County Engineer's Office  
Author: Marcia Wolfe  
Date: 7/10/2020